

nutribullet®

XXL DIGITAL AIR FRYER



User guide

Important safeguards

When operating your nutribullet® XXL Digital Air Fryer, remember: **safety comes first.**

Warning! To avoid the risk of serious injury, carefully read all instructions before operating your nutribullet®. When using any electrical appliance, basic safety precautions should always be observed, including the following important information.

! Save these instructions! ● FOR HOUSEHOLD USE ONLY

READ ALL INSTRUCTIONS CAREFULLY AND THOROUGHLY BEFORE OPERATING.

GENERAL SAFETY INFORMATION:

- This appliance is not intended for use by persons (including children) with reduced physical, sensory or mental capabilities, or lack of experience and knowledge, unless they have been given supervision or instruction concerning use of the appliance by a person responsible for their safety.
- Children should be supervised to ensure that they do not play with the appliance.
- Unplug from outlet when not in use and before cleaning. Allow to cool down before assembling or disassembling parts, and before cleaning the appliance.
- Routinely inspect your unit for damage. Do not operate any appliance with a damaged cord or plug or after the appliance malfunctions or has been damaged in any manner. Return appliance to the nearest authorized service facility for examination, repair, or adjustment.
- If the supply cord is damaged, it must be replaced by the manufacturer, its service agent or similarly qualified persons in order to avoid a hazard.
- Keep appliance and cord away from children.
- The use of after-market accessory attachments not recommended or sold by the appliance manufacturer may cause injuries or malfunctions.

- For countertop use only. Make sure if the surface is level, clean, and dry. Do not place the unit near the edge of the countertop during use. Never use outlet below counter which can make the cord accessible to children.
- Do not use outdoors.
- Do not let cord hang over edge of table or counter, or touch hot surfaces.
- Do not place on or near a hot gas or electric burner, or in a heated oven.
- Extreme caution must be used when moving an appliance containing hot oil or other hot liquids. Always allow the unit to cool before handling or moving.
- Make sure the unit is clean before operating. Spilled food can create serious burns. Keep appliance and cord away from children. Do not use with an extension cord.
- To protect against fire, electrical shock and injury to persons, do not immerse the unit or cord in water or any other liquid.
- Unplug the appliance when it is not in use, and turn off when putting the Cooking Drawer in the Base or taking it out of the Base.
- Avoid contact with hot surfaces. Use the handle on the Cooking Drawer. During hot air frying, hot steam is released through air vents located on the back. Keep your hands and face away from the steam and from the air vents. Use caution when removing the Cooking Drawer from the appliance as there may be hot steam.
- Do not use this appliance for anything other than its intended use. Misuse may cause injury.
- **Always use insulated oven gloves or use handle or knob if available.**
- **To protect against electrical shock, do not immerse cord, plugs, heating element, or Base in water or other liquid.**

ALWAYS MAKE SURE THE THE COOKING DRAWERS ARE SECURELY LOCKED IN PLACE BEFORE FRYING. DO NOT ATTEMPT TO REMOVE THE COOKING DRAWERS WHILE THE UNIT IS IN OPERATION.

- Always turn the appliance OFF and UNPLUG from the outlet when not in use and before cleaning and storing.
- Never overfill ingredients. Leave at least 50mm of space between your food and the top of the Cooking Drawer. Keep all ingredients within the

drawer and prevent any direct contact with the heating element. Overfilling the unit may result in personal injury, property damage, or affect the safe use of the appliance.

ADDITIONAL SAFEGUARDS:

- Remove and discard any packaging material or promotional labels before using the appliance for the first time.
- To eliminate any potential choking hazard for young children, remove and safely discard any protective coverings or plastic bags that the appliance or its parts may come in.
- **Do not put any non-food items into the Cooking Drawer for the purpose of frying or heating. Do not use the appliance for deep frying with oil.**
- Always make sure the unit is properly and completely assembled before turning on the power and operating the appliance.
- Ensure that the areas immediately under or next to the appliance are clean and dry. **Do not operate when wet.**
- Any significant spillage onto the surface under or around the appliance, or onto the appliance itself, should be cleaned and dried before continuing to use the appliance.
- A slight vibration may occur, and is normal, during operation of the unit.
- When using this appliance, provide adequate air space (at least 200mm) above, below, and on all sides for circulation.
- Do not cover the air outlet vent, located on the back of the unit, while the unit is operating.
- Do not leave the appliance unattended when in use.
- Keep hands, fingers, hair, clothing, and utensils away from the appliance during operation.
- Keep the appliance clean. Refer to the **Care and Maintenance** section for tips and best practices.
- Any maintenance other than cleaning should be performed by an authorized Service Center. Do not attempt to repair or service this appliance yourself. **Contact Customer Service for assistance at nutribullet.com.**

- If any of the contained instructions or warnings are not understood, please **contact Customer Service for assistance at nutribullet.com.**

**! Save these
• instructions!**



Contents

08	What's included
09	Assembly guide
10	Control panel
12	Usage instructions
12	Before first use
13	Assembly
13	Using the Air Fryer
16	Care & maintenance
16	Replacement parts

What's included



base



cooking drawer

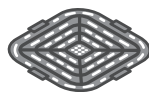

crisping tray



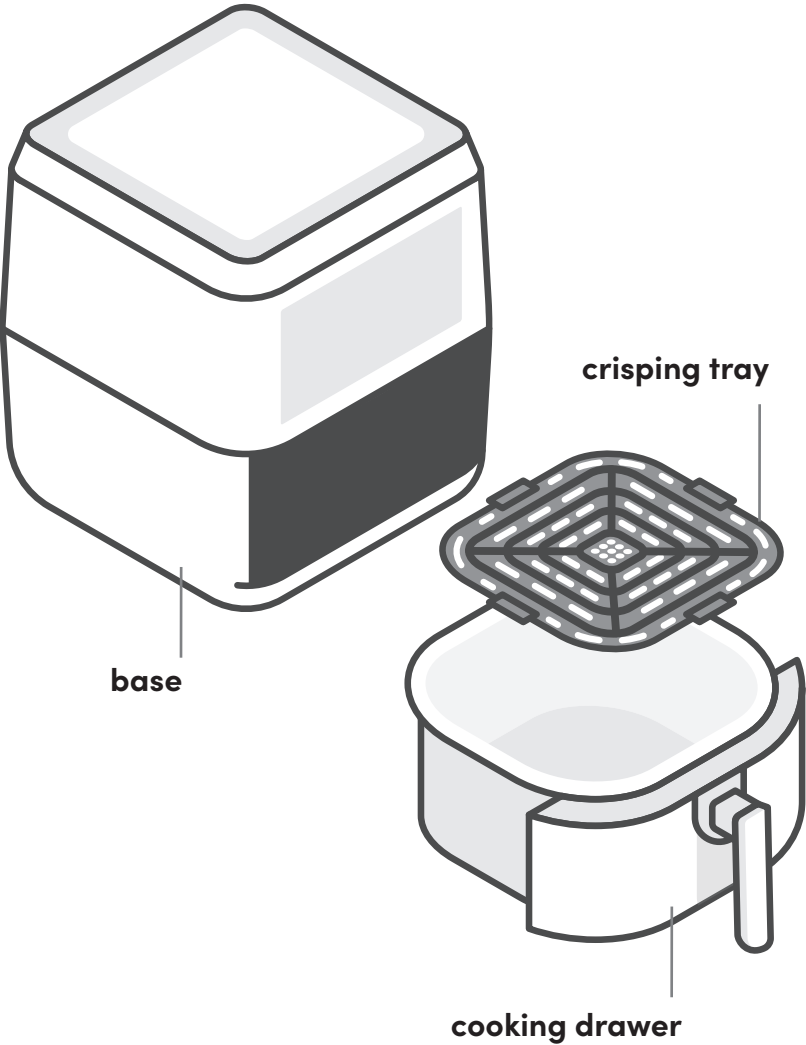



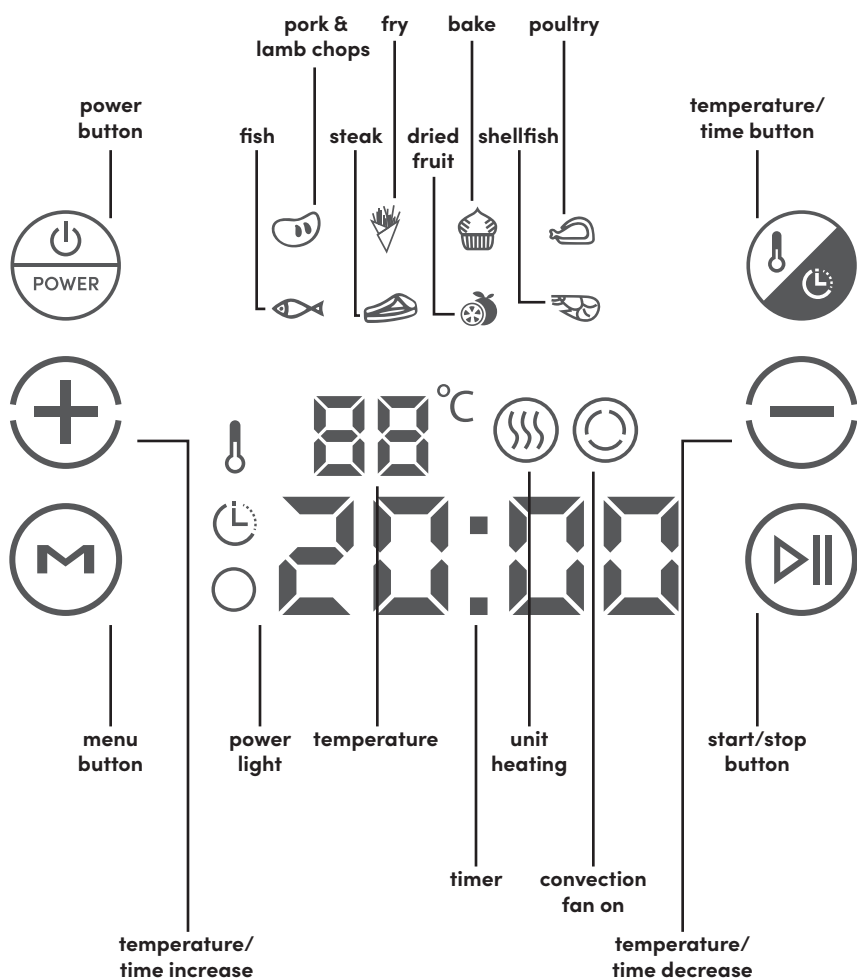

Assembly guide



Control panel



To select a cooking program, press the Menu button until your desired cooking program is flashing. The program will load with its default time and temperature, as noted in the table below. To begin cooking, press the Start/Stop button.

Icon	Program	Default Temperature	Default Cooking Time
	Pork & Lamb Chops	200°C	15 minutes
	Fry	200°C	20 minutes
	Bake	180°C	30 minutes
	Poultry	200°C	20 minutes
	Fish	200°C	12 minutes
	Steak	200°C	25 minutes
	Dried Fruit	30°C	4 hours
	Shellfish	180°C	12 minutes

- The **Temperature/Time** and **+/-** buttons can be used to manually adjust your cooking temperature or time. To adjust the cooking temperature or time before cooking has started, press the **Temperature/Time** button until either reading flashes. When flashing, use the **+/-** to increase or decrease the setting. If you would like to adjust the cooking temperature or time when cooking is already in process, first press the **Start/Stop** button to pause cooking. Then press the **Temperature/Time** button to adjust each setting. Press **Start/Stop** to resume cooking once set.
- If the Air Fryer has been idle for 10 minutes, the unit will enter **Standby** mode. To wake the Air Fryer from **Standby** mode, just press the **Power** button and the full control panel will appear.
- To cancel cooking at any time, press and hold the **Power** button. The unit will power down, the temperature and time readings will flash, and you will hear a series of beeps. After 30 seconds, the **Power** button will reappear. Press the **Power** button to return to the main screen.

Usage instructions

Before first use

Before using your nutribullet® XXL Digital Air Fryer for the first time, please take a moment to perform the steps below.

1. UNPACK

Open the box and remove the air fryer base with cooking drawer and crisping tray, placing all parts on a flat, level, and dry surface.

2. CLEAN

Rinse **Cooking Drawer** and **Crisping Tray** with hot soapy water. Wipe exterior of **Air Fryer Base** with a clean, damp cloth.

3. PREPARE COOKING AREA, ENSURE PROPER VENTILATION

Ensure the **Air Fryer** is used on a clean, dry, flat surface. Do not use the unit outdoors. The **Air Fryer** should be at least 20cm away from the wall when in operation, to ensure proper air ventilation behind the unit.

NOTE: To eliminate any new-machine odors that may be present, you can run the Air Fryer at its highest temperature about 5 minutes without putting any food inside.

NOTE: We suggest placing the unit on top of a heat proof mat to prevent risks of heat damage to surface of benchtop.

Assembly

Review all warning and caution statements in the Important Safeguards section (pages 2-5) and in the section above before proceeding to Step 1.

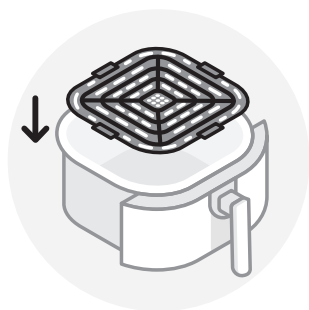

- 1 Insert the Crisping Tray into the bottom of the Cooking Drawer.** Make sure the **Crisping Tray** is seated securely and is level with the bottom of the **Cooking Drawer**.

Using the Air Fryer

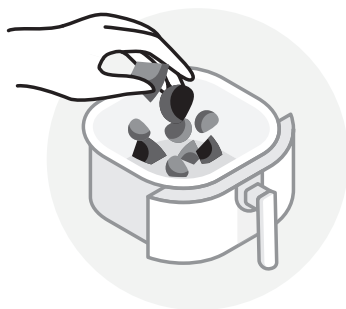

- 1 Place food into the Cooking Drawer, being careful not to overfill.** For best cooking results, leave at least 50mm of space between your food and the top of the **Cooking Drawer**.



- 2 Holding the Cooking Drawer by the handle, place it into the Base.** Ensure the Air Fryer is properly assembled with the **Cooking Drawer** fully seated inside of the **Base**.

NOTE: The Air Fryer will not operate unless the **Cooking Drawer** is installed correctly.

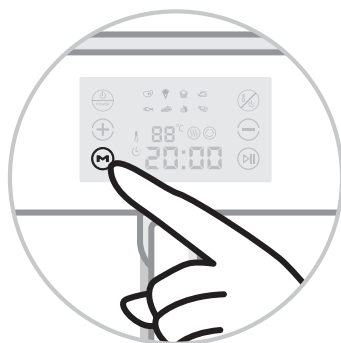

- 3 TO USE A COOKING PROGRAM:** Press the **Menu** button until your desired cooking program flashes. The default time and temperature for the flashing program will load on the **Control Panel**. Press the **Start/Stop** button to begin cooking.

TO USE A MANUAL SETTING: To use a manual setting or to adjust a program's cooking temperature or time after it has been selected, press the **Menu** button and the display will flash. Press the **Time/Temperature** button and use the **+/-** buttons to first adjust the temperature. Once you've reached your desired temperature, press the **Time/Temperature** button again to set. Use the **+/-** buttons to adjust your cooking time. Once you've reached your desired time, press the **Start/Stop** button to set the time and begin cooking.

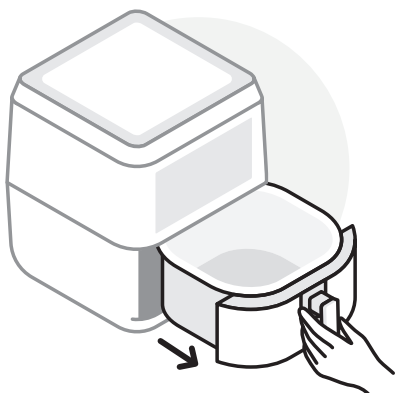

- 4 TURNING FOOD DURING COOKING:** Some recipes call for taking the **Cooking Drawer** out during cooking and turning food. If so, first press the **Start/Stop** button to pause the Air Fryer. When the cooking has paused, remove the **Cooking Drawer** from the **Base** using the handle. Turn your food using a utensil, and place the **Cooking Drawer** securely back in the **Base**. Press the **Start/Stop** button to resume cooking. You may notice that additional time has been added to the timer so that the Air Fryer can adjust its temperature.

WARNING: CONTENTS may be very hot. Use caution when removing the **Cooking Drawer** as there may be hot steam. Keep your hands and face away from the steam and from the air vents.



- 5** Once the Air Fryer has reached the end of its cooking time, you will hear **5 beeps** to alert you that **the cooking has completed**. Wait a few seconds so the cooking action comes to a stop.

CAUTION: Removing the **Cooking Drawer** too quickly may result in splattering and could potentially be dangerous.

CAUTION: Be careful when opening the **Cooking Drawer** as there may be hot steam.

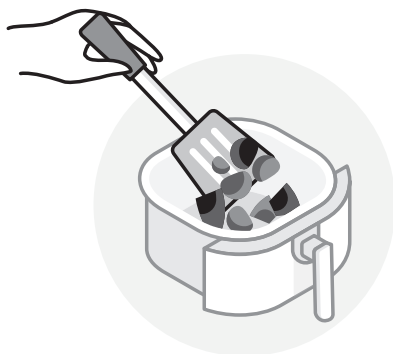

- 6** Remove the food from the **Cooking Drawer** using a utensil – **NEVER** use your hands. Enjoy!

Care & maintenance

Cleaning the nutribullet® XXL Digital Air Fryer is quick and easy. We recommend cleaning all removable parts after each use to reduce the buildup of residue.

STEP 1:

Turn the Air Fryer **OFF**, unplug the unit, and allow it to cool down thoroughly after use.

STEP 2:

Remove the **Cooking Drawer** and **Crisping Tray**. The **Cooking Drawer** and **Crisping Tray** are **TOP RACK** dishwasher safe, or can be cleaned by rinsing in warm soapy water.

 **WARNING:** NEVER use the sanitise cycle – heat this high can warp the plastic.

 **CAUTION:** DO NOT use an abrasive or metal cleaning tool to clean the **Cooking Drawer** or **Crisping Tray**. Doing so can damage the non-stick coating on the surface of these items.

STEP 3:

Clean the inner wall of the **Air Fryer Base** by gently wiping off any residue with a warm cotton cloth, then dry it with a dry cloth. The interior and exterior of the **Base** should only be cleaned by wiping it with a damp cloth.

 **CAUTION:** NEVER submerge the base in water or any other liquid.

STEP 4:

Once all parts have been cleaned and thoroughly dried, store the Air Fryer fully assembled in a safe, dry location.

Replacement parts

To order additional parts and accessories, please visit our website at **[nutribullet.com](https://www.nutribullet.com)**.

Explanation of the marking



This marking indicates that this product should not be disposed with other household wastes throughout the EU. To prevent possible harm to the environment or human health from uncontrolled waste disposal; recycle it responsibly to promote the sustainable reuse of material resources. To return your used device, please use the return and collection systems or contact the retailer where the product was purchased. They can take this product for environmental safe recycling.



The transport and protective packing has been selected from materials, which are environmentally friendly for disposal and can be recycled. Ensure that any plastic, wrappings, bags etc. are disposed of safely and kept out of the reach of babies and young children. Rather than just throwing these materials away, recycle them.



Manufacturer's declaration that product meets the requirements of the applicable EC directives.

220-240VAC 50-60Hz 1800W

Capital Brands Distribution, LLC | nutribullet.com | All rights reserved.

nutribullet® and the nutribullet logo are trademarks of CapBran Holdings, LLC registered in the U.S.A. and worldwide.

Illustrations may differ from the actual product. We are constantly striving to improve our products, therefore the specifications contained herein are subject to change without notice.

230320_NBA93100 (NBA-100)