

PHILIPS

5000 series

XC504*, XC514*

* = 0-9, representing different colors



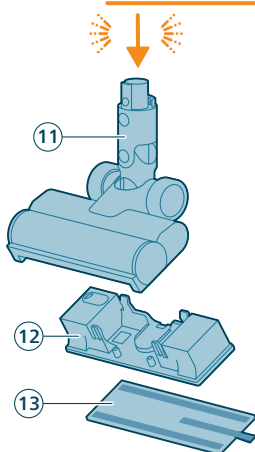
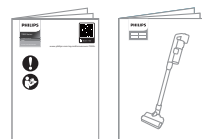
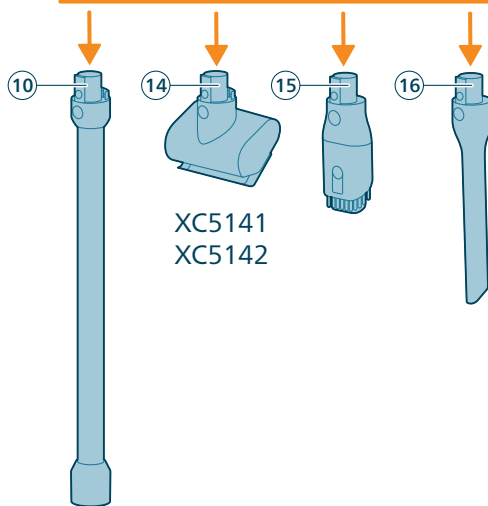
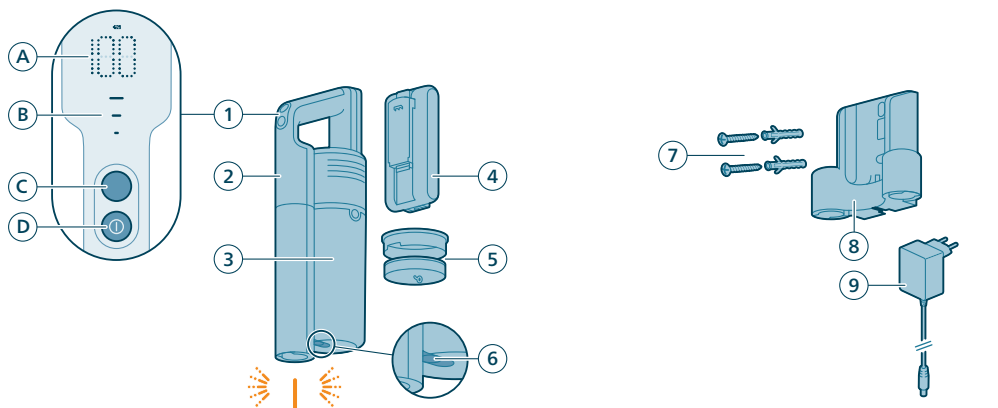

English 4
Bahasa Indonesia 31
Bahasa Melayu 58
Čeština 85
Crnogorski 112
Dansk 139
Deutsch 166
Eesti 193
Español 220
Français 247
Hrvatski 274
Italiano 301
Latviešu 328
Lietuviškai 355
Magyar 382
Nederlands 409
Norsk 436
Polski 463
Português 490
Português do Brasil 517
Română 544
Shqip 571
Slovenščina 598
Slovensky 625
Srpski 652
Suomi 679
Svenska 706
Tiếng Việt 733
Türkçe 760
Ελληνικά 787
Български 815
Македонски 842
Українська 869
ภาษาไทย 896
简体中文 925
繁體中文 952

한국어 977
العربية 1003
فارسی 1029

Contents

Introduction	4
General description	4
Before first use	5
Installing the wall mount	5
Preparing for use	6
Using the appliance	7
Assembling the appliance	7
Vacuuming soft and hard floors	8
Vacuuming while mopping hard floors	9
Versatile usage and accessories	12
Using the nozzle	12
Using the Mini TurboBrush	12
Using the crevice tool	13
Using the combination tool	13
After use – Maintenance	14
Frequent maintenance after each cleaning cycle	14
Dust bucket maintenance	14
Aqua tank maintenance	15
Periodic maintenance intermittently	17
Dust management system maintenance	17
Nozzle maintenance	19
Mini TurboBrush maintenance (XC5141 and XC5142 only)	21
Aqua tank maintenance	21
Replacement	23
User interface signals and their meaning	24
Troubleshooting	26
Dry cleaning	26
When using the Vacuum and Mop Nozzle	29

Introduction

Thank you for buying this product! To fully benefit from the support that we offer, register your product at www.philips.com/support.

General description

- 1 Control panel
 - a Percentage of battery level
 - b Power level indicators
 - c Power selection button
 - d On/off button
- 2 Handheld
- 3 Dust bucket
- 4 Battery
- 5 Filter
- 6 Dust bucket release button
- 7 Screw set

- 8 Wallmount
- 9 Adapter
- 10 Tube
- 11 Nozzle
- 12 Aqua tank
- 13 Microfiber mopping pad
- 14 Mini TurboBrush (XC5141, XC5142 only)
- 15 Combination tool
- 16 Crevice tool

Before first use

Installing the wall mount

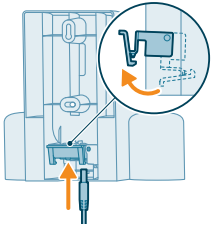

- 1 Invert the wall mount and unlatch the lever. Insert the charging port, ensuring the metal part is visible and pointing upright on the front side of the wall mount.

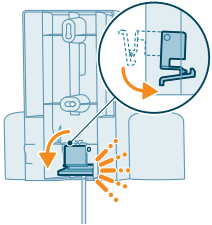

- 2 Close the lever. Make sure the lever is locked in place with a "CLICK" sound.

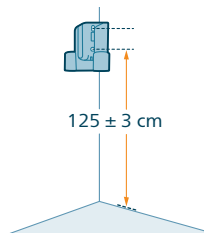

- 3 Securely affix the wall mount to your preferred position on the wall, ensuring that the lowest mounting screw holes are approximately 125 cm from the floor.

⚠ Caution: Be careful when you drill holes in the wall to fasten the wall mount, to avoid the risk of electric shock.

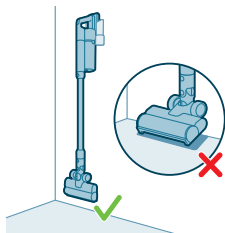

i Note: Verify that the placement of the wall mount allows the entire appliance to hang on the wall without the nozzle coming into contact with the floor.

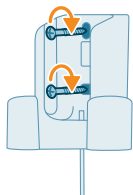

- 4 Once you have determined the optimal position and height for storing and charging your appliance, firmly tighten the screws to secure the wall mount in place.

Preparing for use

The appliance is equipped with a Li-Ion battery. Charging from empty to full takes about 4 hours.

- 1 Attach the battery pack to the main body of the appliance, ensuring a secure connection that's confirmed with a "CLICK" sound.

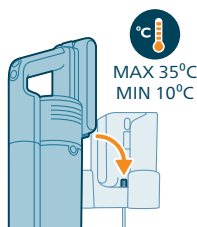
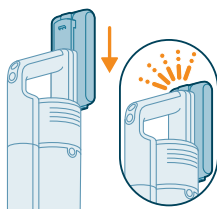

- 2 Charge your appliance by placing it onto the assembled wall mount.

⚠ Warning: Charge the appliance at a temperature above 10 °C and below 35 °C.

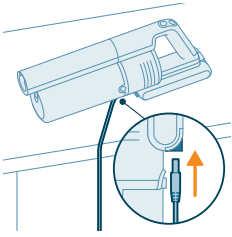

i Note: You can also place the handheld on a level and stable surface, and directly connect the charging cable to the appliance.

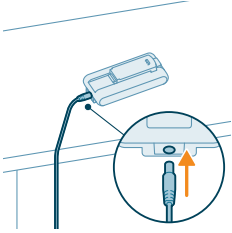

i Note: Another option is to place the battery on a level and stable surface, and directly connect the charging cable to the battery.

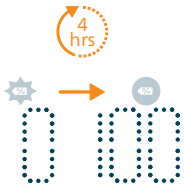

- 3** The appliance is designed to reach a full charge within 4 hours. You can monitor the charging progress on the screen. When the appliance is fully charged, the value 100% lights up on the screen. After a few seconds, the display will turn off.

Using the appliance

Assembling the appliance

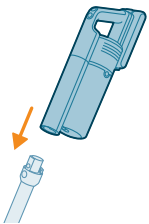

- 1** Attach the handheld to the tube. Confirm the attachment with a "CLICK" sound.

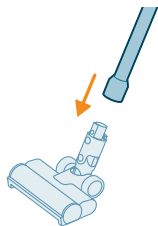

- 2 Attach the tube to the nozzle. Confirm the attachment with a "CLICK" sound.

Vacuuming soft and hard floors

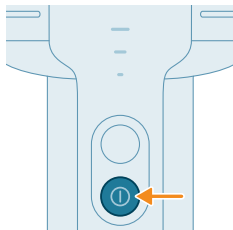

- 1 Press the on/off button to switch on the appliance.

i Note: To switch off the appliance, press the on/off button again.

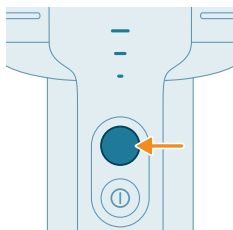

- 2 Use the power selection button to toggle through three different power settings: eco mode, normal mode, turbo mode.

Eco

Normal

Turbo

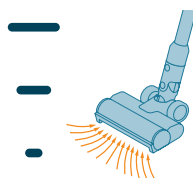
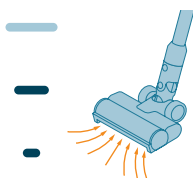
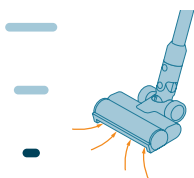

- 3 You can clean on hard or soft floors with the vacuum cleaner.



⚠ Warning: Do not vacuum up water or other liquids.

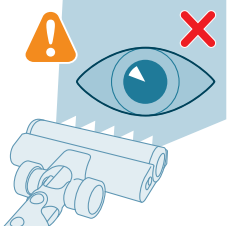

⚠ Caution: Do not look directly into the illuminated LEDs or point the LEDs at someone's eyes. The LED light is very bright.

Vacuuming while mopping hard floors

⚠ Caution: Only use the aqua tank on hard floors with a water-resistant top coat (such as linoleum, enameled tiles and varnished parquet) and stone floors (such as marble). If your floor has not been treated to make it water-resistant, check with the manufacturer if you can use water to clean it. Do not use the aqua tank on hard floors of which the water-resistant top coat is damaged.

i Note: Do not use the aqua tank to clean carpets.

i Note: Do not move the appliance with aqua tank assembled sideways, as this leaves water traces. Only move forwards and backwards.

1 Pre-wet the microfiber mopping pad with water before use.

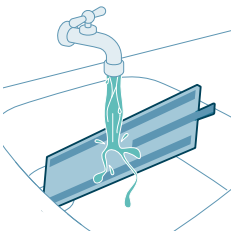

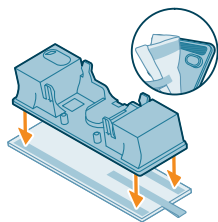

- 2 Secure the microfiber mopping pad underneath the aqua tank. Align the velcro straps under the aqua tank and behind the cloth.

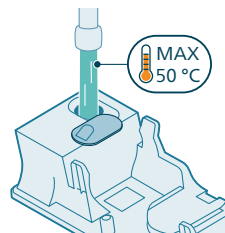

- 3 Open the rubber cap on top of the tank. Fill the tank with water, ensuring the water temperature does not exceed 50 °C.

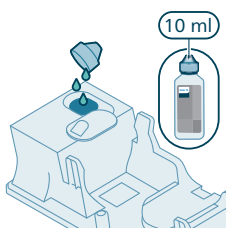

- 4 (Optional) If you wish to add a liquid floor cleaner into the aqua tank, opt for a low-foaming or non-foaming variety that can be diluted. We recommend the XV1792 Philips Floor Cleaner. Add only a few drops of the liquid cleaner to the water.

- 5 Close the aqua tank properly.

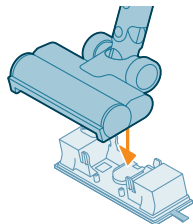
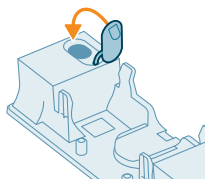

- 6 Attach the prepared aqua tank to the aqua nozzle and you're set to begin. For proper usage, it is essential to firmly attach the tank to the wheels of the nozzle when it's at the correct orientation.



- 7 Press the on/off button to switch on the appliance. You can effectively clean hard floors with the attached aqua module on the nozzle.



i Note: The aqua module is not suitable for soft floors like carpet.



⚠ Caution: The aqua module should not be used to pick up water puddles.

Tips and other important information

- It is not necessary to vacuum the floor before mopping, as the Vacuum & Mop set-up actively wet-cleans your hard floor to capture all kinds of dirt, including liquids and stains. On carpets and rugs, use the Vacuum only set-up.
- The appliance can leave a small puddle of water on the floor if you do not move the appliance while switching it off. You can reduce the size of the puddle by moving the appliance while switching it off. If needed, you can remove the last drops with a cloth.

Usage restrictions

- The Vacuum & Mop set-up is suitable for vacuuming and mopping all types of hard floors, except uncoated wooden floors.
- The Vacuum & Mop set-up is intended for regular cleaning of hard floors. Always follow the cleaning instructions for your hard floor when you use this appliance.
- If you want to add a liquid floor cleaner other than XV1792 Philips Floor Cleaner to the water in the clean aqua tank, make sure that you use a low-foaming or non-foaming liquid floor cleaner that can be diluted in water like XV1792 Philips Floor Cleaner.
- As the clean aqua tank has a capacity of 300 ml, you only have to add a few drops (max 10ml) of liquid floor cleaner to the water.
- If you use the Vacuum & Mop set-up on linoleum floors, only do so on linoleum floors that are properly affixed to prevent linoleum from being drawn into the nozzle.
- If you move/lift the appliance over a carpet or rug when it is switched off, wastewater droplets may end up on your carpet or rug.
- Do not push the appliance over the floor grilles of convector heaters. As the appliance cannot pick up water that comes out of the nozzle when you move it over the grille, water ends up at the bottom of the convector pit.

- While cleaning, do not lift the nozzle from the floor or move the nozzle sideways, and do not make strong turns, as this leaves water traces. Only move forwards and backwards.

i Note: The operating time depends on the power level used during cleaning.

Versatile usage and accessories

⚠ Warning: When using any accessory, do not vacuum up water or other liquids.

Using the nozzle

- 1 Attach the nozzle directly to the handheld.

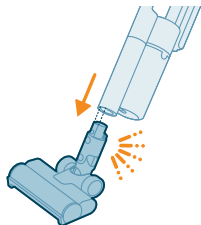

- 2 This combination is for cleaning dynamic surface height, such as stair case.

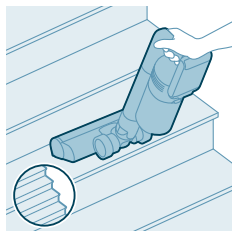

Using the Mini TurboBrush

- 1 To attach the Mini TurboBrush, insert the tube of the handheld into the Mini TurboBrush.



- 2 You can use the Mini TurboBrush for standard cleaning, for instance of soft areas such as beds and couches. You can adjust the power setting to suit your cleaning needs.
- 3 You can use the Mini TurboBrush for extra thorough cleaning, for instance to vacuum up pet hair, or to clean small patches of dirt, such as spilled breadcrumbs. You can adjust the power setting to suit your cleaning needs.

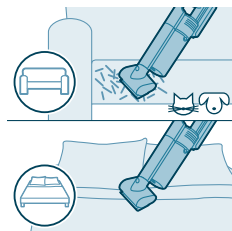

Using the crevice tool

- 1 To attach the crevice tool, insert the tube or handheld into the crevice tool.

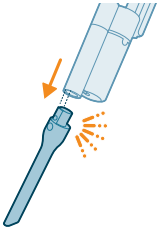

- 2 You can use the long crevice tool to clean narrow corners or hard-to-reach places. You can adjust the power setting to suit your cleaning needs.

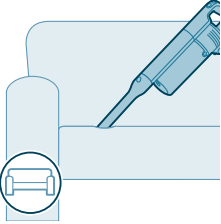

Using the combination tool

- 1 To attach the combination tool, insert the tube or handheld into the combination tool.

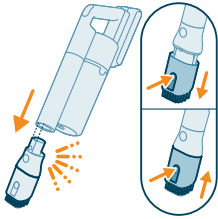

- 2 The combination tool is designed for cleaning window frames, curtains, or spider webs, with a customizable brush release and illumination settings.

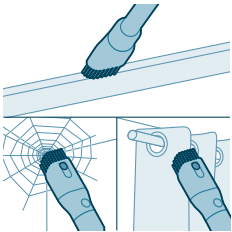

After use – Maintenance

Frequent maintenance after each cleaning cycle

Dust bucket maintenance

Empty the dust bucket after each use or when the dust is reaching the MAX level indicator.

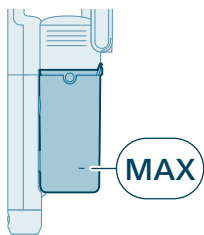

- 1 Switch off the appliance.

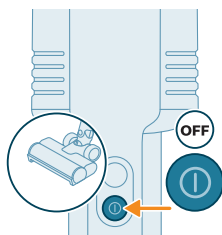

- 2 Hold the appliance in a 45 degree angle as shown in the illustration. Remove the dust bucket by pressing the release button, located at the bottom of the bucket.

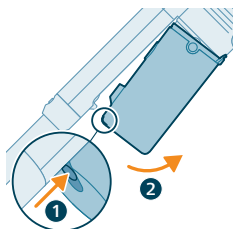

i Note: Remove the dust bucket while keeping the appliance in an upright position to avoid spillage of pollution.

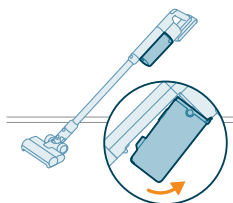

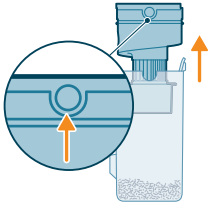

- 3** Hold onto the two dented circles on the side of the cyclone. Remove the cyclone from the dust bucket by lifting it out from the bucket

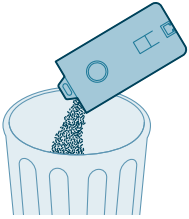

- 4** Empty the collected dust in the dust bucket over the trash bin.



- 5** Place the cyclone back in the dust bucket. Make sure the two parts are aligned: the two semicircles must be connected to each other.

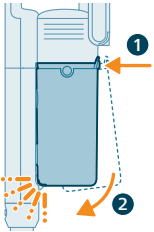

- 6** Place back the assembled bucket. First align the filter side of the bucket before hinging it in place.

Aqua tank maintenance

Clean the aqua tank after each use.

- 1** Remove the microfiber mopping pad.

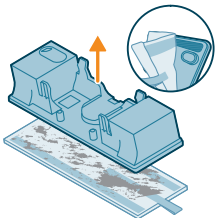

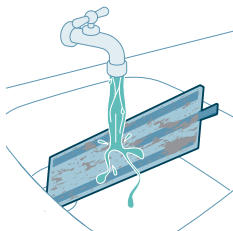

- 2** Rinse the mopping pad under the tap and wash it by hand or in a washing machine.

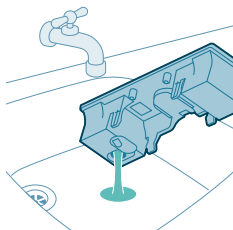

- 3** Pour out any remaining water in the aqua tank.

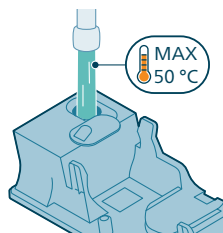

- 4** Fill the aqua tank with water.

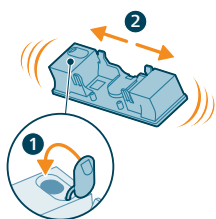

- 5** Close the aqua tank properly and shake the aqua tank to remove detergent residuals.

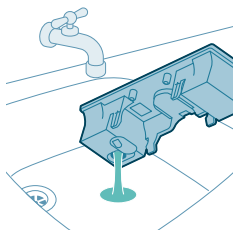

- 6** Empty the aqua tank and leave it open to dry.

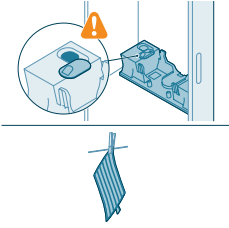

- 7** Make sure to not lose the tank cap during storage. Hang the microfiber mopping pad dry.

i Note: We recommend replacing the microfiber mopping pad every 6 months (accessory XV1630).

Periodic maintenance intermittently

Dust management system maintenance

For optimal performance, we recommend cleaning the filter of your vacuum cleaner monthly and replacing the filter every six months (accessory XV1651).

- 1** Lift the filter to remove it from the dust bucket.

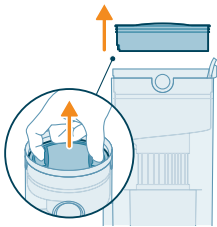

- 2** Remove the washable foam filter from the plastic filter casing.

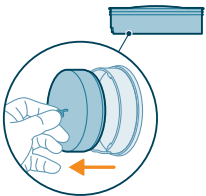

- 3** Tap both the filter casing and the foam filter over a trash bin.

i Note: Make sure to clean the filter case thoroughly by tapping it firmly over a trash bin until no more dust is released from the filter case.



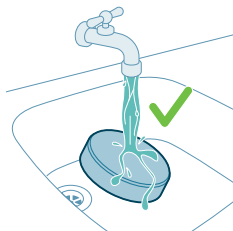

- 4 Rinse the foam filter under the tap.



- 5 Squeeze the foam filter till clean water comes out.

i Note: for best cleaning result, run the water through the filter with the dirtier side facing downwards, allowing deeply set dust to be washed out.

i Note: Do not rinse the filter case.

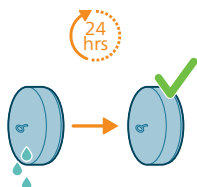

- 6 Leave the washed filter to dry for 24 hours before reassembling the foam filter in the filter casing.

i Note: do not dry the sponge filter in direct sunlight, on the radiator or in the tumble dryer.

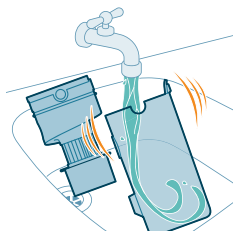

- 7 For thorough maintenance, clean the dust bucket and cyclone under a running tap or in warm soapy water.

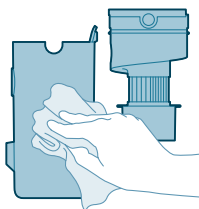

- 8 Wipe the cleaned dust bucket and cyclone dry.

⚠ Caution: Make sure all parts are completely dry before you reassemble them.

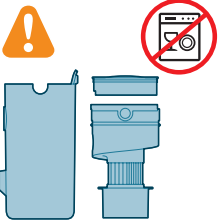

i Note: all parts cannot be cleaned in the dishwasher.

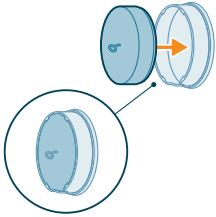

9 Insert the form filter into the filter casing.

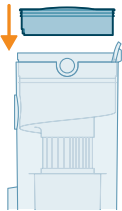

10 Reassemble the filter in the dust bucket.

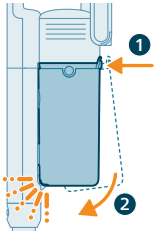

11 Place back the assembled bucket. First align the filter side of the bucket before hinging it in place.

i Note: After maintenance, always make sure the filter is assembled in the appliance before using it.

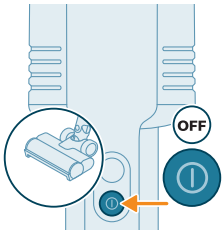

Nozzle maintenance

1 Always switch off the appliance before cleaning the nozzle brush.

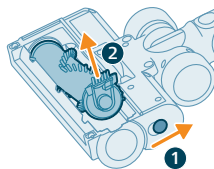

-
- 2 Hold the button on the side of the nozzle with one hand while removing the brush with the other hand.

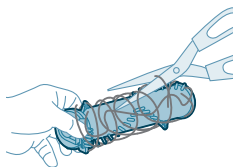

-
-
- 3 Carefully detach any tangled hair from the brush. Support the removal of pollution with a pair of scissors.

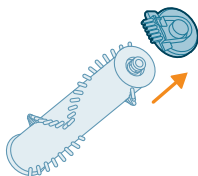

-
-
-
- 4 Remove the side cap.

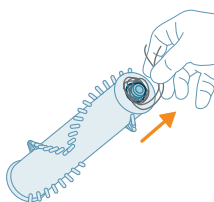

-
-
-
-
- 5 Detach any tangled hair in the brush.

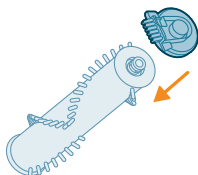

-
-
-
-
-
- 6 Reassemble the cap.

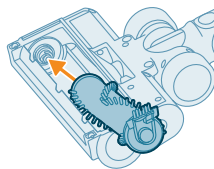

- 7 When reassembling the brush, ensure proper alignment by first placing one side in position before clicking in the other side.

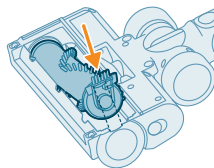

- 8 Lock the nozzle brush by securing it until you hear a "CLICK" sound.

i Note: Check and remove any pollution around the nozzle wheels.

Mini TurboBrush maintenance (XC5141 and XC5142 only)

- 1 Rotate the side lock counter-clockwise to release the brush from its position.

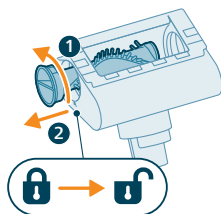

- 2 Use your hands or a pair of scissors to remove any pollution from the brush.

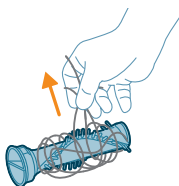

- 3 When reassembling the brush, simply align the brush back in its original position. Make sure the inner end is aligned. Rotate clockwise to lock the brush. When the brush is properly assembled, you will hear a "CLICK" sound.

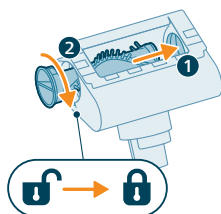

Aqua tank maintenance

Descale the aqua tank once every month to avoid limescale build-up.

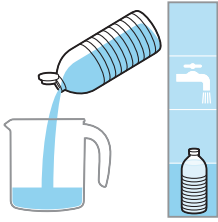

- 1 Add some descaling liquid to a measuring cup.

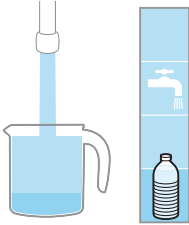

- 2 Add the correct amount of water in the measuring cup.

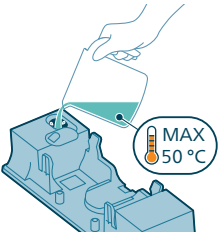

- 3 Add the mixed liquid in the aqua tank.

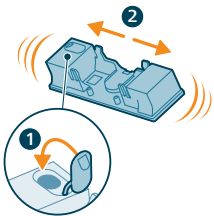

- 4 Close the Aqua tank properly before shaking the tank for the descaling liquid to spread evenly.

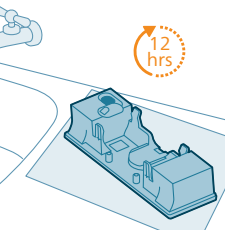

- 5 Leave the aqua tank (without the microfiber mopping pad) upright over 12 hours. Water is expected to slowly come out from the bottom of the aqua tank. We recommend to place the aqua tank inside the sink or over a cloth.

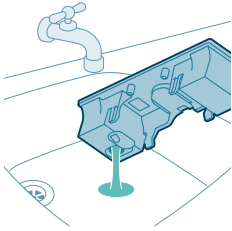

- 6 Rinse and remove any remaining liquid inside the aqua tank.

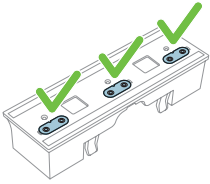

i Note: Always make sure the three water strips are in place. the water tank only functions properly when all three waters strips are in place.

Replacement

To buy accessories or spare parts, visit www.philips.com/parts-and-accessories or go to your Philips dealer. You can also contact the Philips Consumer Care Center in your country.

Replacement parts and type numbers:

Replacement filter XV1651/01

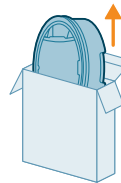

XV1651/01

Battery XV1653/01

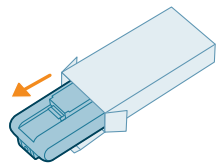

XV1653/01

Microfiber mopping pad XV1630/01

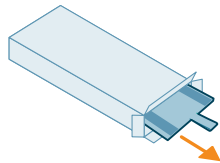

XV1630/01

i Note: Replace the filter and the microfiber mopping pad every 6 months to ensure maximum performance.

User interface signals and their meaning

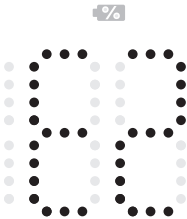
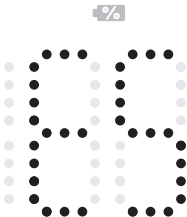
Signal	Meaning of signal
<div>E2</div> <div></div>	The appliance is operated above or below the functioning temperature. Please use and store the appliance in a room with a temperature between 0 °C and 35°C. Charge the appliance or battery at a temperature between 10 °C and 35 °C.
<div>E5</div> <div></div>	The battery does not have enough power to be switched on. Connect the appliance again to the charger. If the appliance still does not charge, take it to a Philips service center or contact the Consumer Care Center.

Signal

Meaning of signal

E9



There is a short circuit in the nozzle.

Take it to a Philips service center or contact the Consumer Care Center.

i4



The brush is stuck or objects are stuck in the air flow channel.

Make sure the appliance is switched off. Clean the nozzle according to the user manual and check the tube by removing the tube from the main appliance. Remove the object in the nozzle or tube and restart the appliance.

When used on certain carpets, the brush may become stuck. If this happens, adjust the floor cleaning direction and power mode to continue cleaning.

i5



The motor is jammed or damaged.



Remove the battery, wait 10 seconds, and then put the battery back. If this does not work, please take the appliance to a Philips service center or contact the Consumer Care Center.

i6

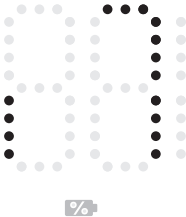

The display shows i6 (seen from upside down with the battery icon under i6). The adapter is not removed.

Remove the adapter before operating the appliance.

Signal	Meaning of signal
i7 	The display shows i7 (seen from upside down with the battery icon under i7). A wrong adapter is used. Make sure that you use the adapter supplied.
	The battery level is low and needs to be charged. Charge the appliance or the battery via the suggested charging methods.

Troubleshooting

This chapter summarizes the most common problems you could encounter with the appliance. If you are unable to solve the problem with the information below, visit www.philips.com/support for a list of frequently asked questions or contact the Consumer Care Center in your country.

Dry cleaning

Problem	Possible cause	Solution
The appliance does not respond when the on/off button is pushed.	The display shows the battery empty icon.	To charge the battery, connect the appliance to the charging station or attach the handheld (with the battery installed) directly to the power plug of the adapter.
The charging station is not stable on the wall.	The screws holding the charging station are loose.	Tighten the screws.
	The screws are not the right size.	Mount the charging station with the supplied screws.
	The charging station is not attached to a stable wall.	Check that the wall on which the charging station will be mounted is stable.
The appliance suddenly stops working.	When the appliance has an internal malfunction, the buttons will not respond and the screen will remain blank.	Connect the appliance to the charging station or attach the handheld vacuum cleaner directly to the adapter. Check the display. If an error code appears, you can find its meaning in the previous chapter about user interface signals.

Problem	Possible cause	Solution
	(code: E2) The appliance is not working at a suitable temperature.	Use and store the appliance at a temperature between 0 °C and 35 °C. Charge the appliance or battery at a temperature between 10 °C and 35 °C.
	(code: i4, i5) The brush is stuck or objects are stuck in the air flow channel.	Make sure the appliance is switched off. Clean the nozzle according to the instructions and check the tube by removing the tube from the main appliance. Remove the object in the nozzle or tube and restart the appliance.
	(code: E9) The motorized nozzle is short circuited.	Take it to a Philips service center or contact the Consumer Care Center.
The appliance has a lower suction power than usual.	The filter and the cyclone are dirty.	Empty the dust bucket. Clean the filter and the cyclone according to the instructions. Make sure the filter is washed at least once a month, when using the appliance regularly. Make sure hair and dirt stuck in the cyclone are removed.
	The dust bucket is not attached properly to the appliance.	Make sure the dust bucket is attached properly.
	The filter has expired and needs to be replaced.	If it is no longer possible to clean the filter according to the instructions, you can buy new filters in the online Philips shop at www.philips.com/support or at your Philips dealer.
Dust escapes from the appliance.	The filter is dirty.	Clean the filter according to the instructions.
	The filter is not present in the appliance.	Make sure that the filter is in the appliance and assembled correctly.
	Something is blocking the cyclone.	Check the cyclone for stuck objects and remove any object blocking the cyclone. Also ensure all hair and dirt stuck in the cyclone are removed.
	The dust bucket is not properly attached to the appliance.	Empty the dust bucket and attach it correctly to the appliance.
	The appliance is rotated or flipped when the power is off.	Keep the appliance upright when the power is off.
The appliance does not move smoothly across the floor when cleaning a carpet.	The selected suction power has been too high.	Try all three power settings and locate the one that works best for your maneuverability needs.
	The vacuuming direction is not aligned with the direction of the carpet piles.	Check the direction of the carpet piles and adjust the vacuuming direction to align with the direction of the piles.

Problem	Possible cause	Solution
The brush does not turn anymore.	The brush is clogged with hair or dirt.	Clean the brush by hand or with a pair of scissors.
	(code i4) The brush may stop turning when it encounters too much resistance from a high-pile carpet.	Adjust the carpet cleaning directions and power modes to continue cleaning.
	The roller brush has not been assembled properly into the nozzle after cleaning.	Follow the instructions in the cleaning chapter of the user manual to slide the roller brush into the nozzle properly. Confirm your assembly with the "click" sound.
	(code: E9) The motorized nozzle is short circuited .	Take it to a Philips service center or contact the Consumer Care Center.
The LEDs in the nozzle do not come on.	The nozzle has not been attached to the tube or appliance properly.	Attach the nozzle to the appliance or handheld properly.
The appliance is not charging.	The power plug is not connected properly to the appliance or the adapter is not inserted into the wall socket properly.	Make sure that the power plug is connected properly to the appliance and that the adapter is inserted into the wall socket properly.
	The power plug is not placed properly in the charging station.	Make sure the plug is fixed properly in the charging station. Check if the plug is angled and the charging station is holding the plug in place.
	(code i7) An adapter other than the supplied adapter is being used.	Make sure that you use the adapter supplied.
	(code E5) The battery malfunctions.	The battery has failed. Replace the battery.
		If you have checked the above and the appliance still does not charge, take it to a Philips service center or contact the Consumer Care Center.
The appliance is charging very slow.	An external adapter or an adapter from other appliances is used.	Charge the appliance with the supplied adapter.
The battery is charged and attached, but the appliance cannot be switched on.	The appliance is still connected to the adapter.	Remove the appliance from the adapter before restarting it.
	Something is wrong with the appliance.	Take it to a Philips service center or contact the Consumer Care Center.

Problem	Possible cause	Solution
The Mini TurboBrush does not function properly.	The roller brush is blocked.	Remove hairs from the brush with a pair of scissors. Follow the instructions in the user manual.
	The roller brush is blocked by fabric or surfaces during cleaning.	Keep the Mini TurboBrush aligned with the surface and do not push the Mini TurboBrush into soft surfaces.
	The roller brush is not properly inserted into the Mini TurboBrush.	Make sure that roller brush and the Mini TurboBrush are properly connected and that there is no gap between the parts. Follow the instructions in the manual.
The appliance delivers static shocks.	The appliance builds up static electricity. The lower the air humidity, the more static electricity is built up.	Discharge the appliance by frequently holding the tube against other metal objects in the room (for example the legs of a table or chair, etc.). Or raise the air humidity level in the room.
	The dust and dirt that is vacuumed up is static.	Empty the dust bucket and clean the filter according to the instructions in the previous chapter.

When using the Vacuum and Mop Nozzle

Problem	Possible cause	Solution
The water flow from the water tank is reduced.	The microfiber mopping pad is not placed correctly and blocks the wetting strip as a result.	Make sure that you place the mopping pad correctly. Check the instructions in the previous chapters for proper placement.
	The water tank is empty or nearly empty.	Refill the water tank.
	A microfiber mopping pad is used that is not supplied by Philips.	Only use an original Philips microfiber mopping pad. The mopping pads can be bought in the online Philips shop at www.philips.com/support or at your Philips dealer.
	Lime scale has built up in the wetting strip.	Buy a new wetting strip in the online Philips shop at www.philips.com/support or at your Philips dealer.
Too much water flows out of the water tank at a too high speed.	The water tank cap is not attached properly.	Check the cap and make sure it is fully and properly closed.
	One or more water strips are missing from the bottom of the water tank.	Check if all three water strips are present below the tank and placed in the correct orientation. If it is assembled correctly, the three water strips should be flush with the surfaces around it.

Problem	Possible cause	Solution
The floor dries with stripes.	Too much liquid cleaner has been added to the water.	Use only a few drops of liquid cleaner or use a cleaner that foams less.
	The microfiber mopping pad is not placed correctly.	Make sure that the mopping pad is placed correctly. Check the instructions in previous chapters for proper placement.
	An incorrect mopping pad is used.	Only use Philips XV1630/01 microfiber mopping pad. The mopping pads can be bought in the online Philips shop at www.philips.com/support or at your Philips dealer.