

PHILIPS

Water Solutions

Under-the-sink filtration

AUT8940

AUT8950

AUT8960



User manual

EN	User manual	1
CZ	Návod k použití	21
DE	Benutzerhandbuch	41
ES	Manual del usuario	61
FR	Manuel d'utilisation	81
IT	Manuale per l'utente	101
NL	Gebruiksaanwijzing	121
PL	Instrukcja obsługi	141

CONTENTS

I. Product introduction	01	VI. Maintenance	12
		1. Routine maintenance	12
		2. Filter lifetime	13
II. Product specification	02	3. Filter replacement	13
		4. Filter reset	15
III. Product overview and installation illustration	03	VII. Precautions	16
		Warning	16
IV. Installation	04	VIII. Troubleshooting	17
1. Before installation	04		
2. Installation Steps	05	IX. Guarantee & Service	18
V. Using the system	10		
1. Before the first-time use	10	X. Packing list	19
2. User interface	11		

I. Product introduction

Congratulations on your purchase and welcome to Philips!

This ultra-compact reverse osmosis water filter is designed to maximize space efficiency. It can be installed vertically or horizontally under your sink or even in the under-plinth, making it ideal for smaller kitchens.

The reverse osmosis membrane has a deep filtration level down to 0.0001 micron, which effectively removes viruses, bacteria, heavy metals, pesticides, water hardness, volatile organic compounds, chlorine, and more, giving you great tasting water.*

Read this user manual carefully before you use the appliance. Save it for future reference.

* Tested by international certification and testing agency under laboratory conditions.

II. Product specification

Product name	Philips Reverse Osmosis Under-the-Sink Water Filtration system	
Product model	AUT8940/10 AUT8950/10	AUT8960/10
MF water flow rate	2 liters/minute	
RO water flow rate	1.05 liters/minute	1.57 liters/minute
Filter cartridges filtration capacity	Compound filter: 1 year RO filter: 3 years	
Inlet water pressure	0.1-0.4 MPa**	
Inlet water temperature	5 °C - 38 °C	
Rated voltage	AC 220-240 V	
Rated power	72 W	90 W
Dimensions	L402*W110*H313mm	
Applicable water source	Municipal tap water, which meets all European Directive on Water for Human Consumption 98/83 requirements and its national transpositions in the various EU member states.	

** When the inlet water pressure exceeds 0.4 MPa, a pressure relief valve should be installed before the system. When the inlet water pressure is below 0.1 MPa, a pressure booster should be installed before the system. The pressure relief valve is included in the accessories bag and the pressure booster needs to be purchased separately.

III. Product overview and installation illustration

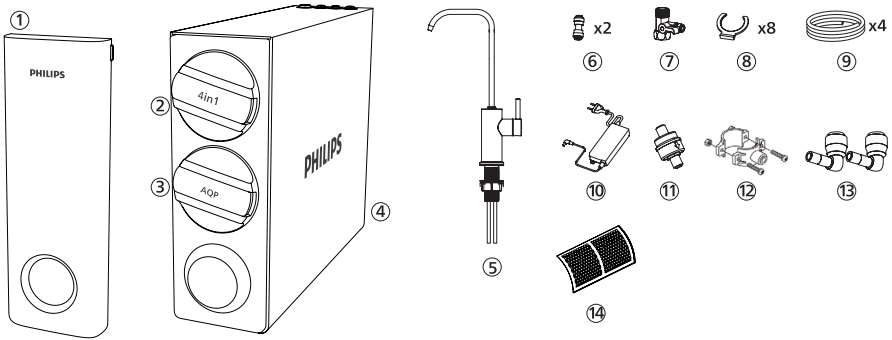

- ① Front cover
- ② Compound filter
- ③ RO filter
- ④ Main unit
- ⑤ Faucet
- ⑥ Quick connector
- ⑦ Three-way ball valve
- ⑧ Quick connector clip
- ⑨ $\frac{3}{8}$ " PE pipe (white)
- $\frac{1}{4}$ " PE pipe (blue)
- $\frac{1}{4}$ " PE pipe (grey)
- $\frac{1}{4}$ " PE pipe (green)
- ⑩ Power adapter
- ⑪ Pressure relief valve
- ⑫ Drain connector
- ⑬ Elbow connector
- ⑭ Mounting mat

IV. Installation

1. Before installation

a. Important notes

- Before installation, it is important to check the condition of the system to make sure it has not been damaged during transport.
- Unpack the system and its accessories. Remove the protective packaging material. Recyclable materials have been used for the packaging and should be disposed of in the appropriate recycling bins or at the specific local recycling center.
Warning: Keep plastic bags out of the reach of children as they can pose a danger.
- Check if anything is missing according to the packing list and the overview.
- Given that the system will improve the quality of your drinking water, all tools to be used in the installation process should be clean, rust and grease-free.
- The installation process should be carried out under appropriate hygienic conditions, ensuring that all necessary precautions are taken regarding materials and components that will come into contact with the water to be treated or consumed.
- Avoid external contamination of the system through improper handling, using gloves, sanitizing gel, and washing hands as often as necessary during the installation process, first use, and system maintenance.
- The system and installation shall comply with applicable local regulations.
- This product cannot be disposed of with other domestic waste products. At the end of the product's service life, it should be returned to the place of purchase, or at a local recycling center, indicating that it contains electric and electronic components
- The appropriate collection and treatment of the product, which no longer is to be used, contributes to the preservation of natural resources and avoids any potential public health risks.

b. Preparations before installation

- Choose a suitable position to install the system;
- Make sure there is a power socket near the installation position;
- Check the packing list and make sure you have all the accessories on the list;

c. Prepare necessary tools for installation:

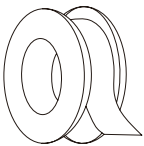

PTFE tape



Screwdriver



Wrench



Pipe cutter

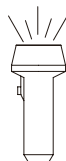

Flashlight



Rag

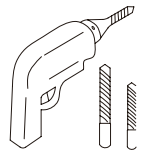

Electric drill

2. Installation Steps

Step 1: Installing the three-way ball valve

a. Preparation:

- Turn off the cold water supply.
- Turn on the kitchen cold water faucet to release the pressure and allow water to drain from the line. Disconnect the cold water hose from the cold water valve.

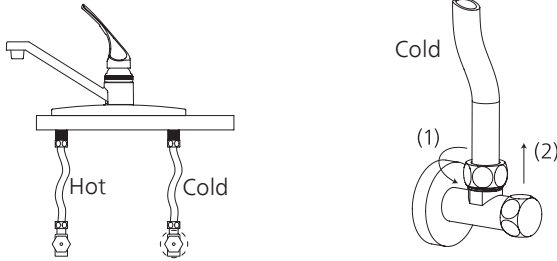

b. Install the three-way valve:

- Insert the nut of the three-way ball valve onto the 3/8" white PE pipe and insert the pipe into the convex connector of the three-way ball valve. Tighten the nut with a wrench.

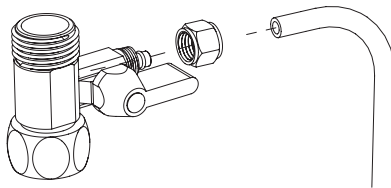

- Install the three-way ball valve on the cold water valve. Make sure the gasket inside the valve is in place before tightening.

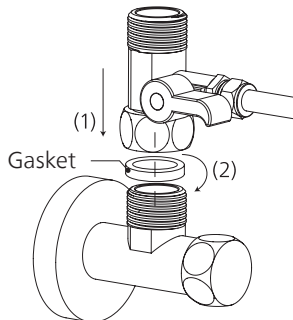

c. Reconnect the cold water hose:

- Connect the cold water hose with the three-way ball valve and screw it tightly with a wrench. Make sure the gasket inside the valve is in place before tightening.

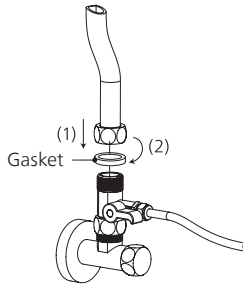

d. Switch off the three-way ball valve:

- Turn on the cold water supply. Wipe the connections with a tissue to see if there is leakage. If the tissue stays dry, the three-way ball valve is installed properly

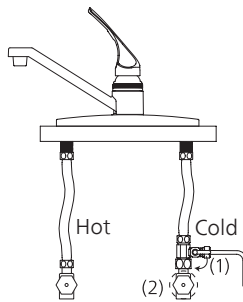

Step 2: Install the Faucet

a. Before installation

- A 29mm faucet hole is required. If not available, drill one or have a professional do it.

WARNING: Always wear safety glasses.

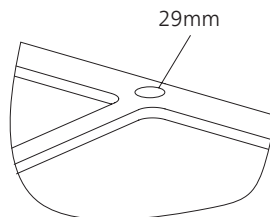

b. Install the faucet

- Install accessories for the faucet (e.g., Rubber washer) as shown in the figure below.
- Thread the faucet stem nut onto the faucet stem and tighten it securely.
- Insert the faucet inlet pipes into the quick connectors and secure them with clips.

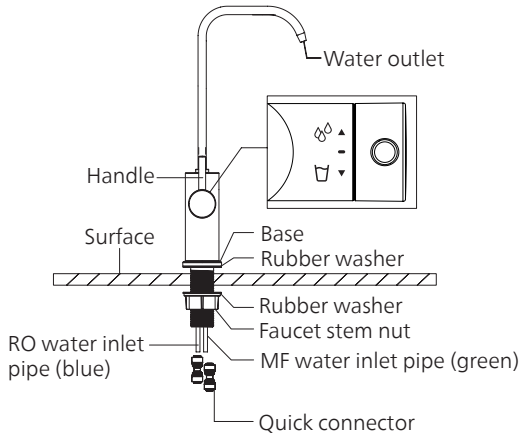

Step 3: Install the main unit

a. Before installation

- Place the system on a stable, flat surface and connect the water inlet, outlet, and drain.
- Ensure the system is on a dry surface, away from heat sources.

b. Install the tap water pipe (white) and three-way ball valve

- Insert one end of the $\frac{3}{8}$ " white PE pipe into the "Water in" on the top of the unit.
- Connect the other end to the three-way ball valve.
- Secure the pipe with a clip.

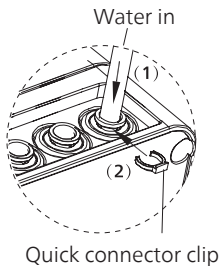

c. Install the drain saddle and drain pipe (grey)

- Drill a 6.5mm hole in the drain pipe at a suitable location. Install the drain connector as shown in the diagram and tighten the nuts securely.
- Cut a suitable length of 1/4" grey PE pipe, insert one end into the "Waste" on the top of the unit, and connect the other end to the drain pipe.
- Secure the pipe with a clip.

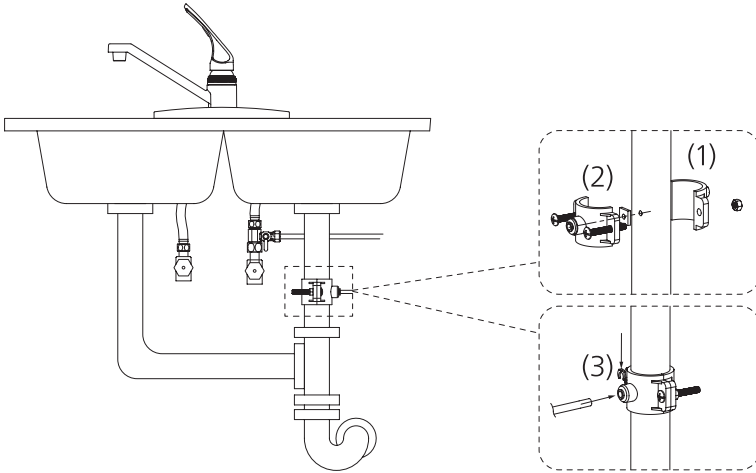

d. Install the MF water water pipe (green)

- Cut a suitable length of 1/4" green PE pipe, insert one end into the "MF water" on the top of the unit, and connect the other end to the faucet.
- Secure the pipe with a clip.

e. Install the RO water water pipe (blue)

- Cut a suitable length of 1/4" blue PE pipe, insert one end into the "RO water" on the top of the unit, and connect the other end to the faucet.
- Secure the pipe with a clip.

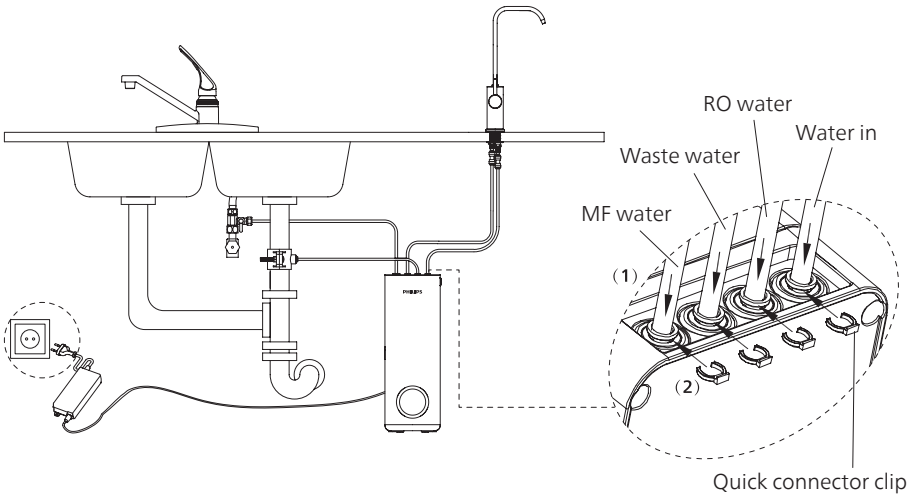

Horizontal Installation:

This machine can also be installed horizontally. To install it horizontally, please follow these steps:

- Place the two mounting mats on the installation location.
- Insert the four elbow connectors into the machine.
- Place the machine completely onto the pads.
- Follow the installation steps b to e above

Note:

- Do not install the drain connector onto the same drain pipe as the garbage disposal.
- Avoid drilling through the opposite side of the pipe.

f. After confirming the machine is properly installed, turn on the three-way ball valve.

g. Connect the power adapter to the system and power on the machine.

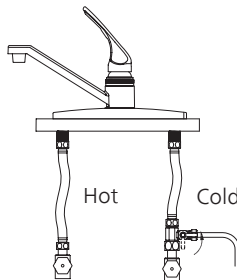

V. Using the system

1. Before the first-time use

a. Automatic flush:

- When the machine is powered on, it will beep, and all indicator lights will stay on for 3 seconds.
- The system will automatically flush for 18 seconds. Check for any leaks during this process.

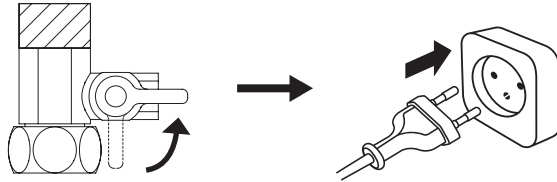

b. Manual flush:

- Turn on the MF water and let it run for 15 minutes.
- Return the tap handle to the middle position and wait for 10 seconds.
- Turn on the RO water and let it run for another 15 minutes.

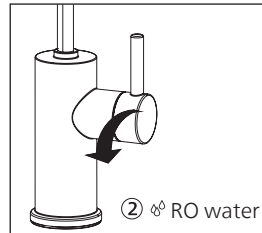
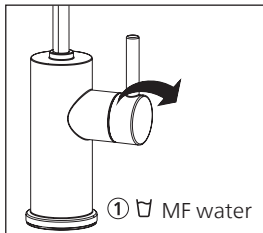

2. User interface

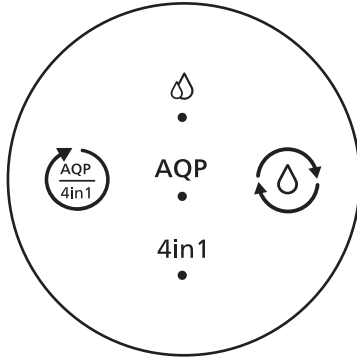

Control Panel



Filter Reset Button:

- Short Press: Select filters.
- Long Press: Reset filters.



Flush Button:

- Long Press for 3 seconds: Start the filter flushing process. The system will automatically exit the flushing mode once completed.

Display Area

Water Production Status:



- Constant blue light: Water is being produced.
- Flashing blue light: The system is flushing.
- Flashing red light (repeated): Fault detected.

AQP

Filter Life Indicator:

- Constant blue light: The filter is within its lifespan.
- Flashing red light: The filter is nearing the end of its lifespan. Replace it soon.
- Red light on: The filter has expired. Replace it immediately

4in1

-

VI. Maintenance

1. Routine maintenance

a. If the system is not used for more than 2 days

- Turn on the RO water and run it for at least 5 minutes to flush the filters and system.

b. If the system will not be used for 7+ days

- Remove the filters, wrap them in plastic, and store them in the refrigerator (not the freezer).
- Before using it again, run the RO water for at least 10 minutes to flush the filters and the system.

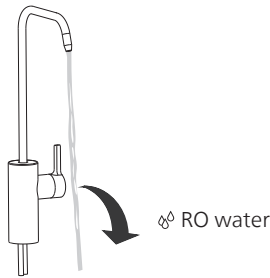

c. If the system will not be used for an extended period

- Turn off the three-way ball valve, run the RO water to empty the system, and turn off the power.
- Before using it again, run the RO water for at least 10 minutes to flush the filters and the system.

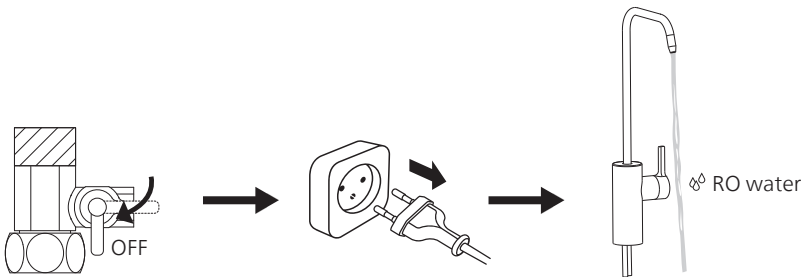

2. Filter lifetime

For optimal performance, please replace the filters based on the lifetime indicator or the recommended replacement cycle below. If you notice a significant drop in water flow, please replace the filters.

This system can only work with Philips filters.

Filter	Filter model code	System model code	Filter lifetime
4-in-1 filter	AUT615	AUT8940 AUT8960	Up to 12 months*
5-in-1 filter	AUT619	AUT8940 AUT8960	Up to 12 months*
RO filter	AUT620R400	AUT8940	Up to 36 months*
RO filter	AUT620R600	AUT8960	Up to 36 months*

* The filter lifetime depends on local water quality and usage. The recommended replacement cycle is an average estimate. If the water quality is poor, the filter may need replacing sooner. Please replace the filter immediately if it becomes blocked.

3. Filter replacement

- Turn off the three-way ball valve, run on the RO water to empty the system, and turn off the power.
- Remove the front cover.

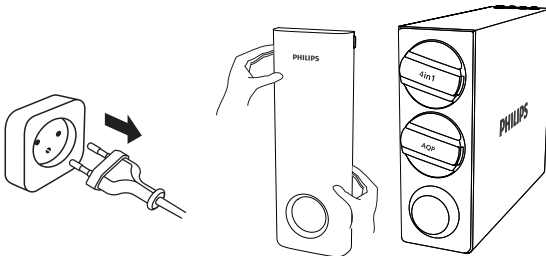

- Turn the handle as shown to unscrew the filter.

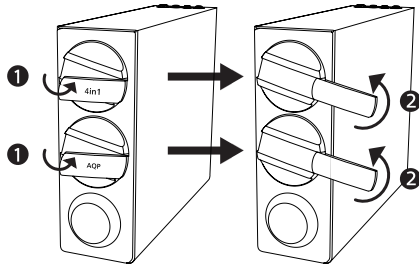

- Install the new filter by rotating it into place as shown.

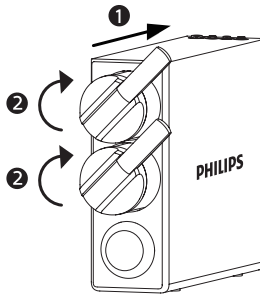

- Push the handle back into position and close the front cover.

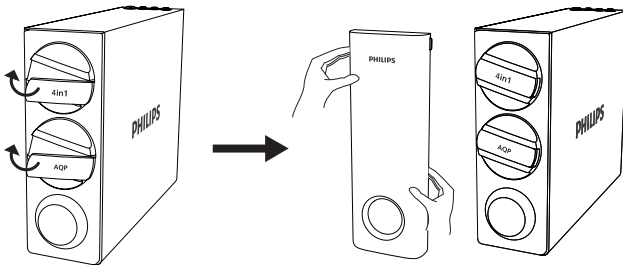

4. Filter reset

a. RO filter reset:

- Press and hold the "AQP 4in1" button for 3 seconds. The "AQP" light flashes.
- Press and hold the "AQP 4in1" button again for 3 seconds. The "AQP" light will switch from flashing to constant, then stay on. A beep will confirm the filter reset is successful.

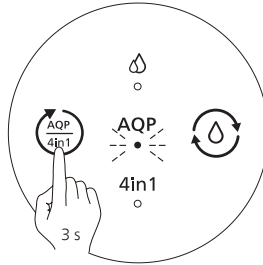

b. 4in1 filter reset:

- Press and hold the "AQP 4in1" button for 3 seconds. The "AQP" light flashes.
- Press "AQP 4in1" button once. The "4in1" light flashes.
- Press and hold the "AQP 4in1" button again for 3 seconds. The "4in1" light will switch from flashing to constant, then stay on. A beep will confirm the filter reset is successful.

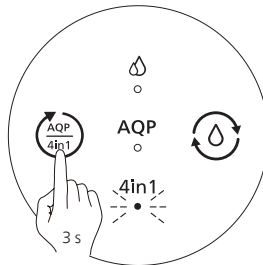

Note:

- Please reset the filter lifetime immediately after replacement, or the system won't track the new filter's lifespan.
- To cancel the filter reset, press and hold both the "AQP 4in1" and "AQP 4in1" buttons for 5 seconds. Reset cancellation is invalid if more than 5 minutes have passed or if the device is powered off.

Note:

- After resetting the filters, repeat the step on page 11

V. Using the system

1. Before the first-time use

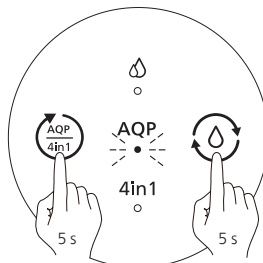

VII. Precautions

Warning

- Always use municipal tap water as the water source. Do not use water that is micro-biologically unsafe or of unknown quality without adequate disinfection before or after the system.
- This system is not intended for use by persons (including children) with reduced physical sensory or mental capabilities, or lack of experience and knowledge unless they have been given supervision or instruction concerning the use of the appliance by a person responsible for their safety. Children should be supervised to ensure that they do not play with the system.
- Be sure to handle the system gently and carefully. Do not attempt to modify or repair the system yourself, otherwise, the warranty becomes invalid.
- The inlet water temperature of the system should be within 5-38 °C. When the inlet water temperature exceeds 38 °C, the filter could be damaged and become invalid. If the inlet water temperature is lower than 5 °C, it may cause freezing and the parts of the system to rupture, resulting in water leakage.
- Do not reverse the installation order of the filter cartridges to avoid affecting the filter performance of the system.
- If the system is abnormal or faulty, stop using it immediately. Close the inlet water valve, and turn on the faucet to empty the system. Events of faults include:
 - Leakage
 - The product is cracked or damaged
 - There is an abnormal sound or burnt smell
 - The power plug or power cord is abnormally hot
 - The machine does not workPlease contact consumer care for inspection immediately.
- If not using the system for an extended period, turn off the water supply, and turn on the faucet to release the internal pressure to avoid damage to the system.

VIII. Troubleshooting

Problem	Posibles causas	Soluciones
No water comes out from the faucet.	Cold water valve or the three-way ball valve is turned off.	Turn on the valves.
	Product not powered on or connection is loose.	Ensure power is connected.
The flow rate gets slower.	Tubing connected incorrectly.	Check tubing and ensure all connections are correct.
	Filter is blocked.	Replace the filter.
	Low water pressure or insufficient water supply.	Ensure the inlet water pressure stabilizes before use. If pressure consistently remains below 0.1 MPa, install a pressure booster upstream of the system.
Poor outlet water quality.	Water tube is bent or folded.	Inspect the water tube, ensure it's straight and unbent.
	Filter has reached the end of life.	Replace the filter.
	Extended Inactivity (24+ Hours).	Let RO water run for 5 minutes before use.
	The inlet water quality is poor.	Only use treated municipal tap water. Untreated or microbiologically unsafe water requires proper disinfection before or after system use.
Operation status indicator lights up in red, and there are beeps.	The system has been filtering water continuously for 30 minutes.	Unplug the system, wait for 1 minute, and plug in again to shoot the trouble.
Filter life indicator failure	The PCB board is damaged.	Contact consumer care.
The flush button doesn't work.	The button module is damaged.	Contact consumer care.
Indicators don't light up.	The system is not connected with power.	Check if the power adapter is connected to the system and the power socket properly.

IX. Guarantee & Service

If you need information or if you have any problems, please visit www.philips.com or contact the consumer care center in your country. If there is no consumer care center in your country, go to a local dealer. Within two years from the date of purchase, you will receive free warranty service for any damage caused by the manufacturing process, or components under normal operation confirmed by our maintenance service. The warranty service does not include frequently replaced consumable components, auxiliary devices, transportation fees, and door-to-door service. Please show the proof of purchase to the service personnel during maintenance.

X. Packing list

Water System (1pc of 4in1 filter included + AQP filter)	1x
Power adapter	1x
Three-way ball valve	1x
Elbow connector 3/8"	1x
Elbow connector 1/4"	3x
Faucet (accessory 1 set included)	1x
3/8" PE pipe (white)	1x
1/4" PE pipe (blue)	1x
1/4" PE pipe (grey)	1x
1/4" PE pipe (green)	1x
Pressure relief valve	1x
Drain connector	1x
User manual	1x
Mounting mat	2x
Quick connector clip 3/8"	3x
Quick connector clip 1/4"	5x
Hose quick connector	2x

Please keep this user manual for future reference.
The information of this user manual is subject to change without prior notice to the users .